

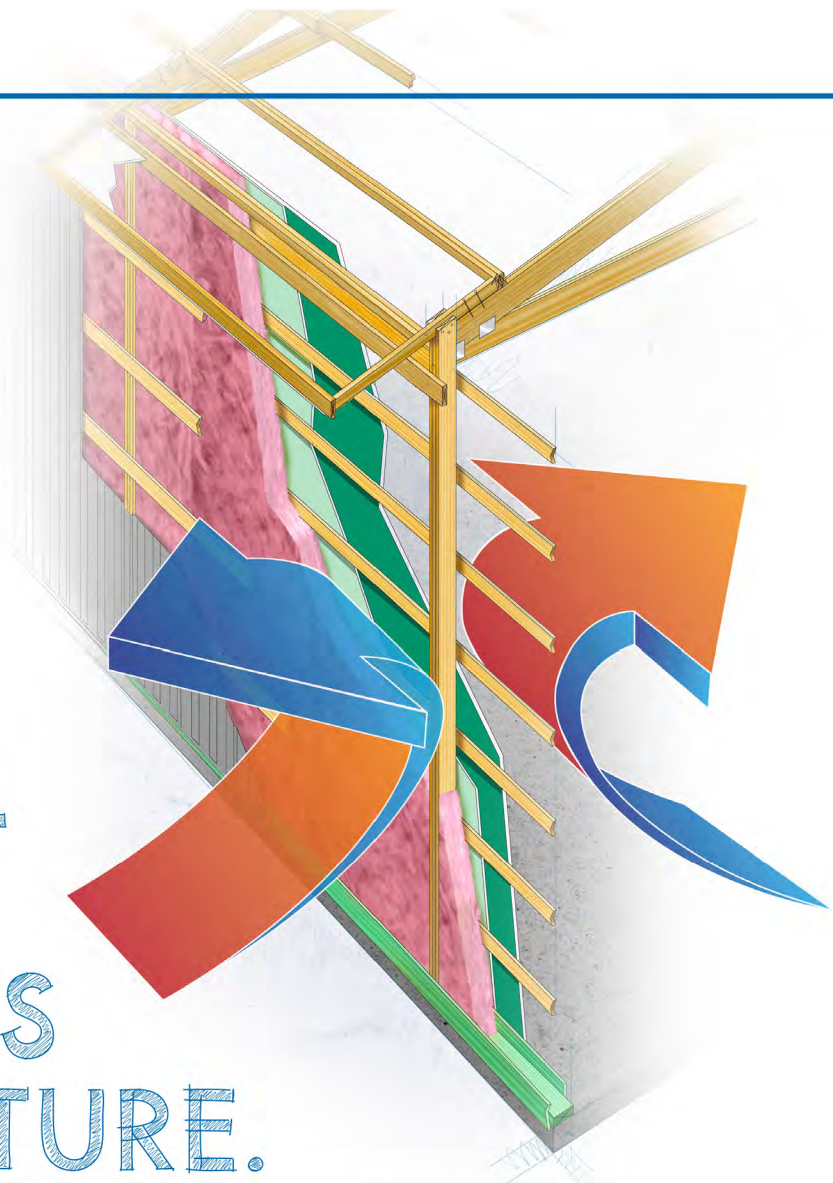

TAKE CONTROL OF YOUR BUILDING'S TEMPERATURE.



And take control of your energy bill.

Your bill shouldn't put you in a state of shock every month — and with Wick Building's insulation, it doesn't have to.

Insulation levels are specified by R-value, which is a measure of the insulation's ability to resist heat traveling through it. The higher the R-value, the better the thermal performance of the insulation — and the better your building maintains its temperature. Wick Buildings provides a wall with total insulating value of R-21.6, which keeps you and your belongings protected from extreme temperatures.

Wick's superior insulation gives you:

- Heating and cooling savings year after year.
- An environmentally-friendly building that is energy-efficient.
- Appropriate building temperatures year-round due to the superior insulating capacities of our flushwall system.

**Choose Wick, and keep your building's temperature,
and yours, right where it should be.**

WickBuildings.com • 800.356.9682

MORE SPACE, LESS COST.

Wall System with Liners

Our column wall design allows for increased energy efficiency. This means there's less obstruction in the wall cavities, providing a 17% greater system R-value than the standard stud wall system. This substantially lowers energy costs for you. Place your electrical materials between the insulation and the finished wall. You've got room!

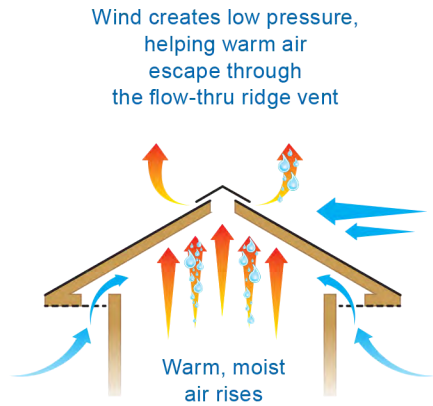
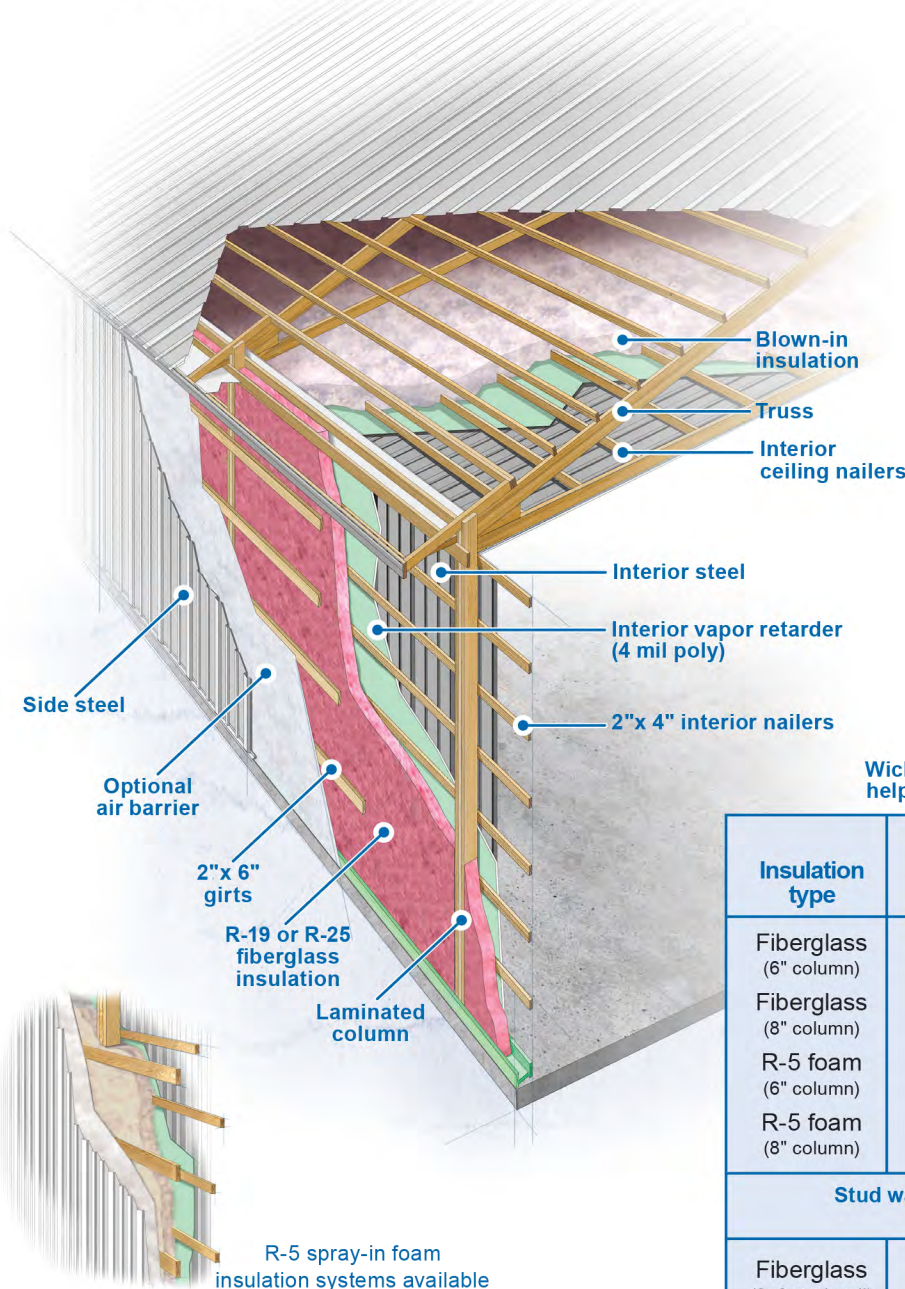

Our Flow-thru Eave and Ridge Ventilation System along with 2-inch air gaps at the eaves help maintain comfortable temperatures and lower moisture through all seasons

Wick's superior R-value wall systems help maintain building temperatures:

Insulation type	Insulation thickness	Raw insulation value	System insulation value
Fiberglass (6" column)	6"	R-19	R-21.5*
Fiberglass (8" column)	8"	R-25	R-27.5
R-5 foam (6" column)	7" (column + girts)	R-27.5	R-34.3
R-5 foam (8" column)	8.75" (column + girts)	R-36.25	R-42.7
Stud wall insulation information for comparison to post-frame wall insulation:			
Fiberglass (2x6 stud wall)	6"	R-19	R-18.3



Visit WickBuildings.com, click on "Find Your Builder" and enter your zip code, or call Wick Buildings at **800.356.9682**.